

**\$ 299 CAT 40**  
**\$ 399 CAT 50**

**T | E | N | D | O<sup>®</sup> Economic**

## Get the best for less

### Why use a hydraulic holder?

- ▶ Easiest holder to use; clamp tools using only a t-handle wrench
- ▶ Excellent run-out accuracy
- ▶ Vibration dampening; smoother cuts / longer tool life

### Why use a SCHUNK TENDO-E hydraulic holder?

- ▶ Over 30 years producing hydraulic holders
- ▶ Largest product offering available
- ▶ Local repair capabilities

**SCHUNK**  <sup>®</sup>

TENDO Hydraulic Expansion Toolholders

TENDO E CAT 40/50

short, rigid design  
with axial length adjustment

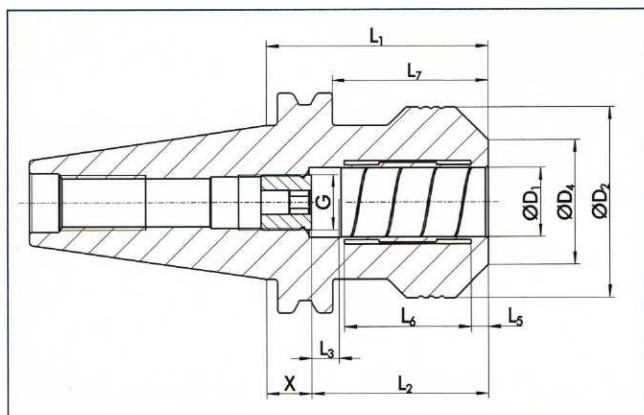

< 0.005 mm



50000 min<sup>-1</sup>



G 6.3



✓



✓



✓



✓



✓

Technical data

| D <sub>1</sub> | ID      | Taper  | D <sub>2</sub> | D <sub>4</sub> | L <sub>1</sub> | L <sub>2</sub> | L <sub>3</sub> | L <sub>5</sub> | L <sub>6</sub> | L <sub>7</sub> | X  | G     | M <sub>min</sub> | m   |
|----------------|---------|--------|----------------|----------------|----------------|----------------|----------------|----------------|----------------|----------------|----|-------|------------------|-----|
| 3/4"           | 0205488 | CAT 40 | 55.0           | 36.0           | 64.0           | 51.0           | 10.0           | 5.0            | 36.5           | 45.0           | 13 | M16x1 | 310              | 1.3 |
| 20 mm          | 0205489 | CAT 40 | 55.0           | 36.0           | 64.0           | 51.0           | 10.0           | 5.0            | 36.5           | 45.0           | 13 | M16x1 | 310              | 1.3 |
| 1-1/4"         | 0205490 | CAT 50 | 85.0           | 55.0           | 81.0           | 61.0           | 10.0           | 4.2            | 47.7           | 61.95          | 20 | M16x1 | 650              | 4.3 |
| 32 mm          | 0205491 | CAT 50 | 85.0           | 55.0           | 81.0           | 61.0           | 10.0           | 4.2            | 47.7           | 61.95          | 20 | M16x1 | 650              | 4.3 |

- Additional sizes can be clamped with intermediate sleeves
- Can be supplied from stock

- Additional sizes and special designs available on request  
Run-out accuracy < 5 microns / 0.0002"

**CAT 50 Holders Available Q4-2009**

SCHUNK reserves the right to discontinue this promotion at any time.



Reg. No. DE-385347 QM



Reg. No. DE-385347 QM

**CONTACT? 800 - 772 - 4865**  
211 Kitty Hawk Drive, Morrisville, NC 27560  
www.schunk.com

